

LEGEND

- Category A (Tree stem and canopy spread)
- Category B
- Category C
- Category U
- Root Protection Area
- Existing Layout
- Site Boundary

NOTES

Purpose of Tree Survey
The tree survey has been carried out in accordance with BS5837:2012 'Trees in relation to design, demolition and Construction - Recommendations'.
The purpose is to illustrate the constraints and opportunities posed by trees and hedgerows, to help the design team prepare a layout that is considerate of the existing canopy cover on and within influencing distance of the site.
Constraints
Tree and hedgerow positions place reliance on topographical survey. The position of trees and hedgerows not recorded on the topographical survey remains indicative.
Scale is for planning purposes only.
Plan should be read in colour and in conjunction with accompanying Tree Schedule.
BS5837 Retention Categories
The purpose of the tree categorization method is to identify the quality and value (in a non-fiscal sense) of the existing tree stock, allowing informed decisions to be made concerning which trees should be removed or retained in the event of development occurring.
Category A
Trees of high arboricultural quality and value in such condition to make a significant contribution for a minimum of 40 years.
Category B
Trees of moderate arboricultural quality and value in such condition to make a substantial contribution for a minimum of 20 years.
Category C
Trees of low arboricultural quality and value currently in adequate condition and able to remain until new planting is established with a minimum useful life expectancy of 10 years, or trees with a stem diameter of <100mm.
Category U
Trees in poor physiological or structural condition that cannot realistically be retained in the context of current land use for longer than 10 years.

Tree Constraints Plan (Insert 2)

PROJECT / SITE	Ardee 2040
CLIENT	Louth County Council
DRAWING REF	21-217-02
REVISION	v1
DATE	06.02.2022
SCALE	1:500@A1
DRAWN BY	JM
CHECKED BY	JL

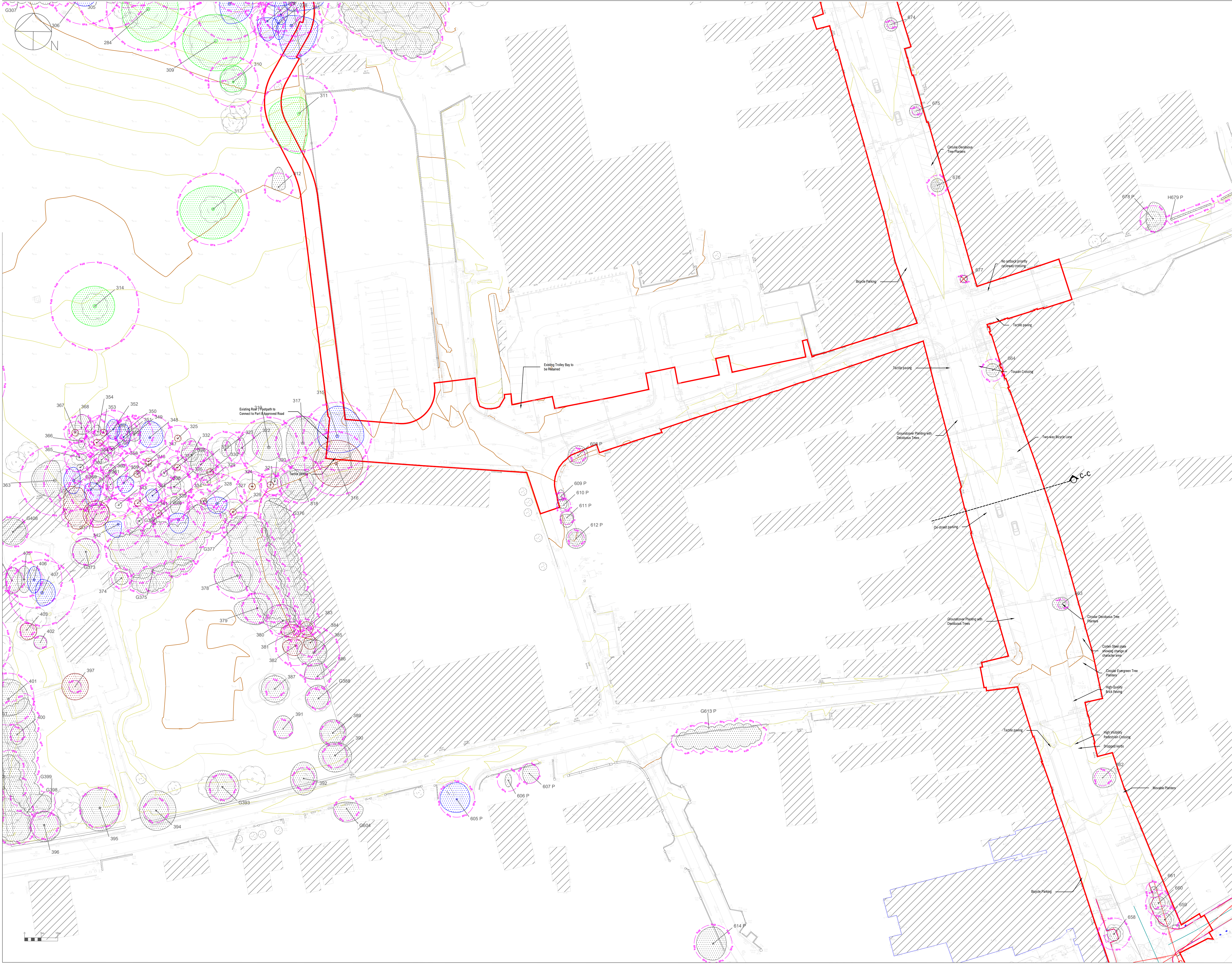

LEGEND

- Category A (Tree stem and canopy spread)
- Category B
- Category C
- Category U
- Root Protection Area
- Existing Layout
- Site Boundary

NOTES

Purpose of Tree Survey
The tree survey has been carried out in accordance with BS5837:2012 Trees in relation to design, demolition and construction - Recommendations.

The purpose is to illustrate the constraints and opportunities posed by trees and hedgerows, to help the design team prepare a layout that is considerate of the existing canopy cover on and within influencing distance of the site.

Caveats
Tree and hedgerow positions place reliance on topographical survey. The position of trees and hedgerows not recorded on the topographical survey remains indicative.

Scale is for planning purposes only.

Plan should be read in colour and in conjunction with accompanying Tree Schedule.

BS5837 Retention Categories
The purpose of the tree categorization method is to identify the quality and value (in a non-fiscal sense) of the existing tree stock, allowing informed decisions to be made concerning which trees should be removed or retained in the event of development occurring.

Category A
Trees of high arboricultural quality and value in such condition to make a significant contribution for a minimum of 40 years.

Category B
Trees of moderate arboricultural quality and value in such condition to make a substantial contribution for a minimum of 20 years.

Category C
Trees of low arboricultural quality and value currently in adequate condition and able to remain until new planting is established with a minimum useful life expectancy of 10 years, or trees with a stem diameter of <150mm.

Category U
Trees in poor physiological or structural condition that cannot realistically be retained in the context of current land use for longer than 10 years.

Tree Constraints Plan (Insert 3)

PROJECT / SITE: Ardee 2040

CLIENT: Louth County Council

DRAWING REF: 21-217-02

REVISION: v1

DATE: 06.02.2022 SCALE: 1:500@A1

DRAWN BY: JM CHECKED BY: JL

This drawing and its contents are the property of John Morris Arboricultural Consultancy and shall not be copied, reproduced or published without the consent of John Morris Arboricultural Consultancy Ltd.

John Morris Arboricultural Consultancy Ltd
Email: jma@johnmorrisarboriculture.com | Website: www.johnmorrisarboriculture.com
Phone: +44 (0) 1509 793 487

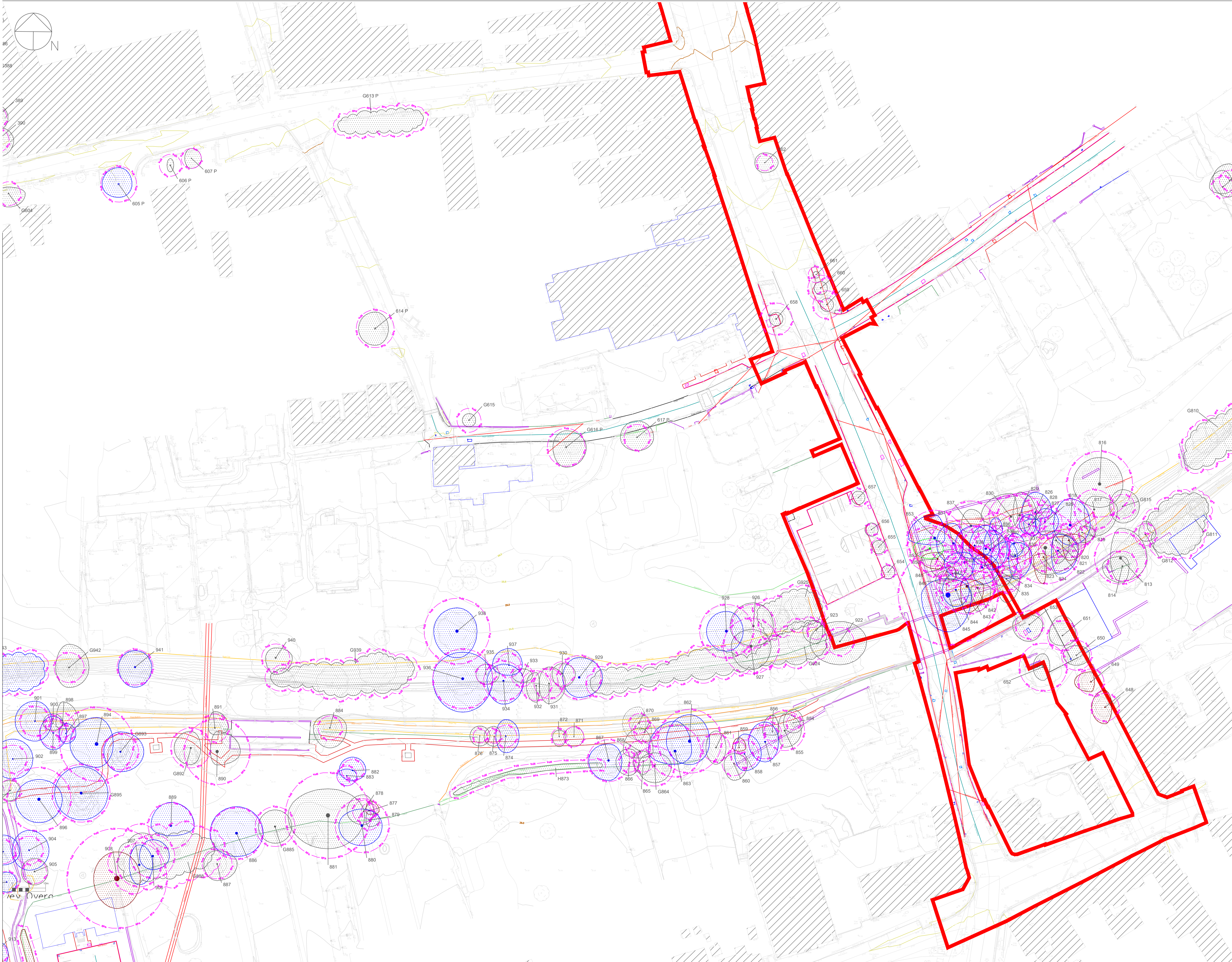

LEGEND

- Category A (Tree stem and canopy spread)
- Category B
- Category C
- Category U
- Root Protection Area
- Existing Layout
- Site Boundary

NOTES

Purpose of Tree Survey
The tree survey has been carried out in accordance with BS5837:2012 'Trees in relation to design, demolition and construction - Recommendations'.
The purpose is to illustrate the constraints and opportunities posed by trees and hedgerows, to help the design team prepare a layout that is considerate of the existing canopy cover on and within influencing distance of the site.

Caveats
Tree and hedgerow positions place reliance on topographical survey. The position of trees and hedgerows not recorded on the topographical survey remains indicative.
Scale is for planning purposes only.
Plan should be read in colour and in conjunction with accompanying Tree Schedule.

BS5837 Retention Categories
The purpose of the tree categorization method is to identify the quality and value (in a non-financial sense) of the existing tree stock, allowing informed decisions to be made concerning which trees should be removed or retained in the event of development occurring.

Category A
Trees of high arboricultural quality and value in such condition to make a significant contribution for a minimum of 40 years.

Category B
Trees of moderate arboricultural quality and value in such condition to make a substantial contribution for a minimum of 20 years.

Category C
Trees of low arboricultural quality and value currently in adequate condition and able to remain until new planting is established with a minimum useful life expectancy of 10 years, or trees with a stem diameter of <150mm.

Category U
Trees in poor physiological or structural condition that cannot realistically be retained in the context of current land use for longer than 10 years.

Tree Constraints Plan (Insert 4)

PROJECT / SITE: Ardee 2040

CLIENT: Louth County Council

DRAWING REF: 21-217-02

REVISION: v1

DATE: 06.02.2022 SCALE: 1:500@A1

DRAWN BY: JM CHECKED BY: JL

This drawing and its contents are the property of John Morris Arboricultural Consultancy and shall not be copied, reproduced or published without the consent of

John Morris Arboricultural Consultancy Ltd
Executive Suite, Riverside Court, Lifford Road, Drogheda, D12 02N1
Email: info@johnmorristrees.com | Website: www.johnmorristrees.com

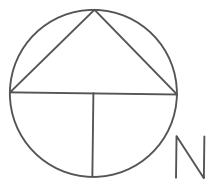

LEGEND

Category A (Tree stem and canopy spread)

Category B

Category C

Category U

Root Protection Area

Existing Layout

Site Boundary

NOTES

Purpose of Tree Survey
The tree survey has been carried out in accordance with BS5837:2012. Trees in relation to design, demolition and construction - Recommendations.

The purpose is to illustrate the constraints and opportunities posed by trees and hedgerows, to help the design team prepare a layout that is considerate of the existing canopy cover on and within influencing distance of the site.

Caveats
Tree and hedgerow positions place reliance on topographical survey. The position of trees and hedgerows not recorded on the topographical survey remains indicative.

Scale is for planning purposes only.
Plan should be read in colour and in conjunction with accompanying Tree Schedule.

BS5837 Retention Categories
The purpose of the tree categorization method is to identify the quality and value (in a non-fiscal sense) of the existing tree stock, allowing informed decisions to be made concerning which trees should be removed or retained in the event of development occurring.

Category A
Trees of high arboricultural quality and value in such condition to make a significant contribution for a minimum of 40 years.

Category B
Trees of moderate arboricultural quality and value in such condition to make a substantial contribution for a minimum of 20 years.

Category C
Trees of low arboricultural quality and value currently in adequate condition and able to remain until new planting is established with a minimum useful life expectancy of 10 years, or trees with a stem diameter of <150mm.

Category U
Trees in poor physiological or structural condition that cannot realistically be retained in the context of current land use for longer than 10 years.

TITLE:
Tree Constraints Plan (Insert 5)

PROJECT / SITE:
Ardee 2040

CLIENT:
Louth County Council

DRAWING REF:
21-217-02

REVISION:
v1

DATE:
06.02.2022

SCALE:
1:500@A1

DRAWN BY:
JM

CHECKED BY:
JL

This drawing and its contents are the property of John Morris Arboricultural Consultancy and shall not be copied, reproduced or published without the consent of

John Morris Arboricultural Consultancy Ltd
Ardee, Co. Louth, Ireland. Tel: 01822 712121
Email: info@johnmorristrees.com | Website: www.johnmorristrees.com



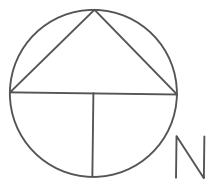

LEGEND

Category A (Tree stem and canopy spread)

Category B

Category C

Category U

Root Protection Area

Existing Layout

Site Boundary

NOTES

Purpose of Tree Survey
The tree survey has been carried out in accordance with BS5837:2012 Trees in relation to design, demolition and Construction - Recommendations.

The purpose is to illustrate the constraints and opportunities posed by trees and hedgerows, to help the design team prepare a layout that is considerate of the existing canopy cover on and within influencing distance of the site.

Caveats
Tree and hedgerow positions place reliance on topographical survey. The position of trees and hedgerows not recorded on the topographical survey remains indicative.

Scale is for planning purposes only.

Plan should be read in colour and in conjunction with accompanying Tree Schedule.

BS5837 Retention Categories
The purpose of the tree categorization method is to identify the quality and value (in a non-fiscal sense) of the existing tree stock, allowing informed decisions to be made concerning which trees should be removed or retained in the event of development occurring.

Category A
Trees of high arboricultural quality and value in such condition to make a significant contribution for a minimum of 40 years.

Category B
Trees of moderate arboricultural quality and value in such condition to make a substantial contribution for a minimum of 20 years.

Category C
Trees of low arboricultural quality and value currently in adequate condition and able to remain until new planting is established with a minimum useful life expectancy of 10 years, or trees with a stem diameter of <150mm.

Category U
Trees in poor physiological or structural condition that cannot realistically be retained in the context of current land use for longer than 10 years.

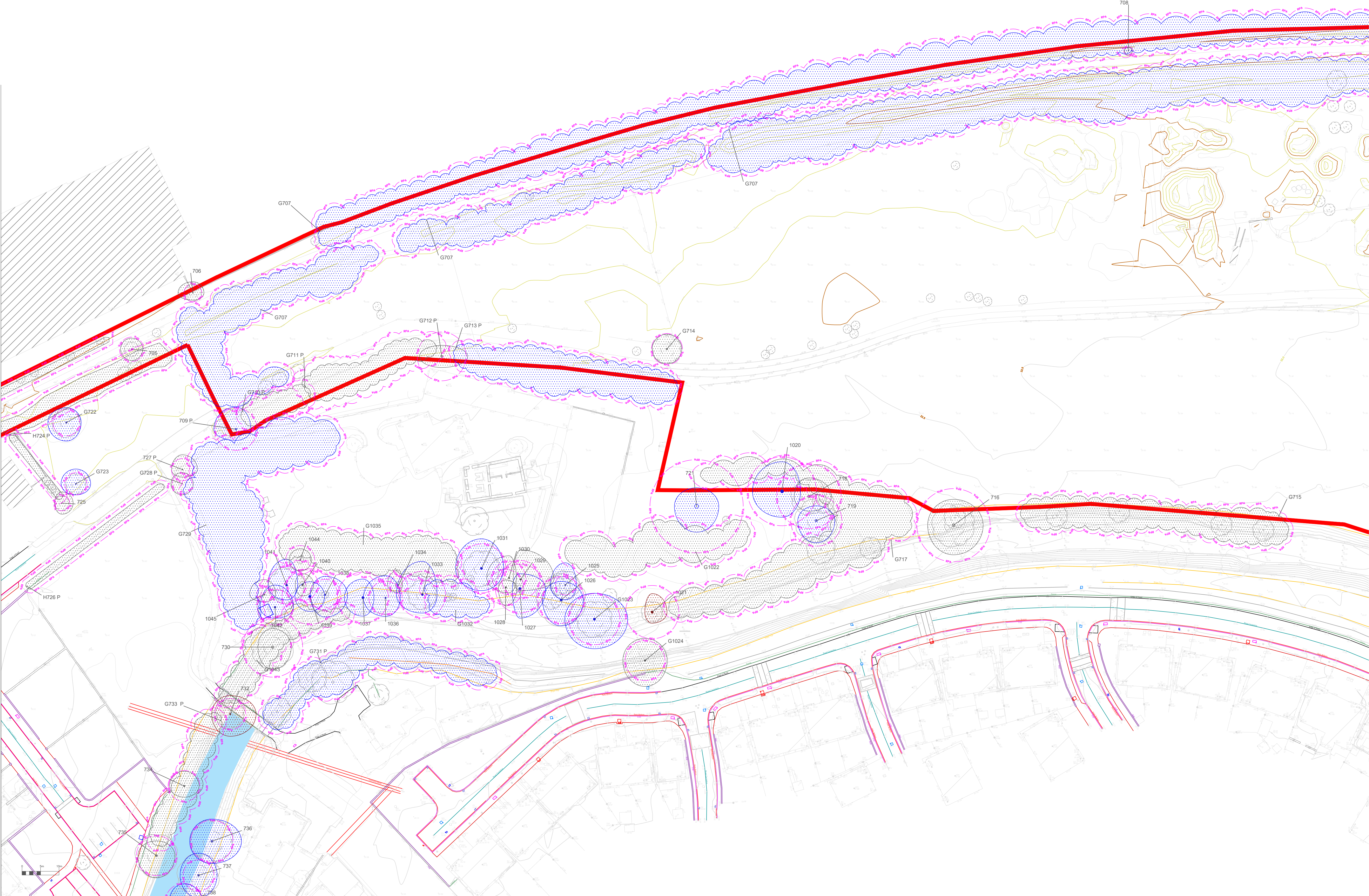

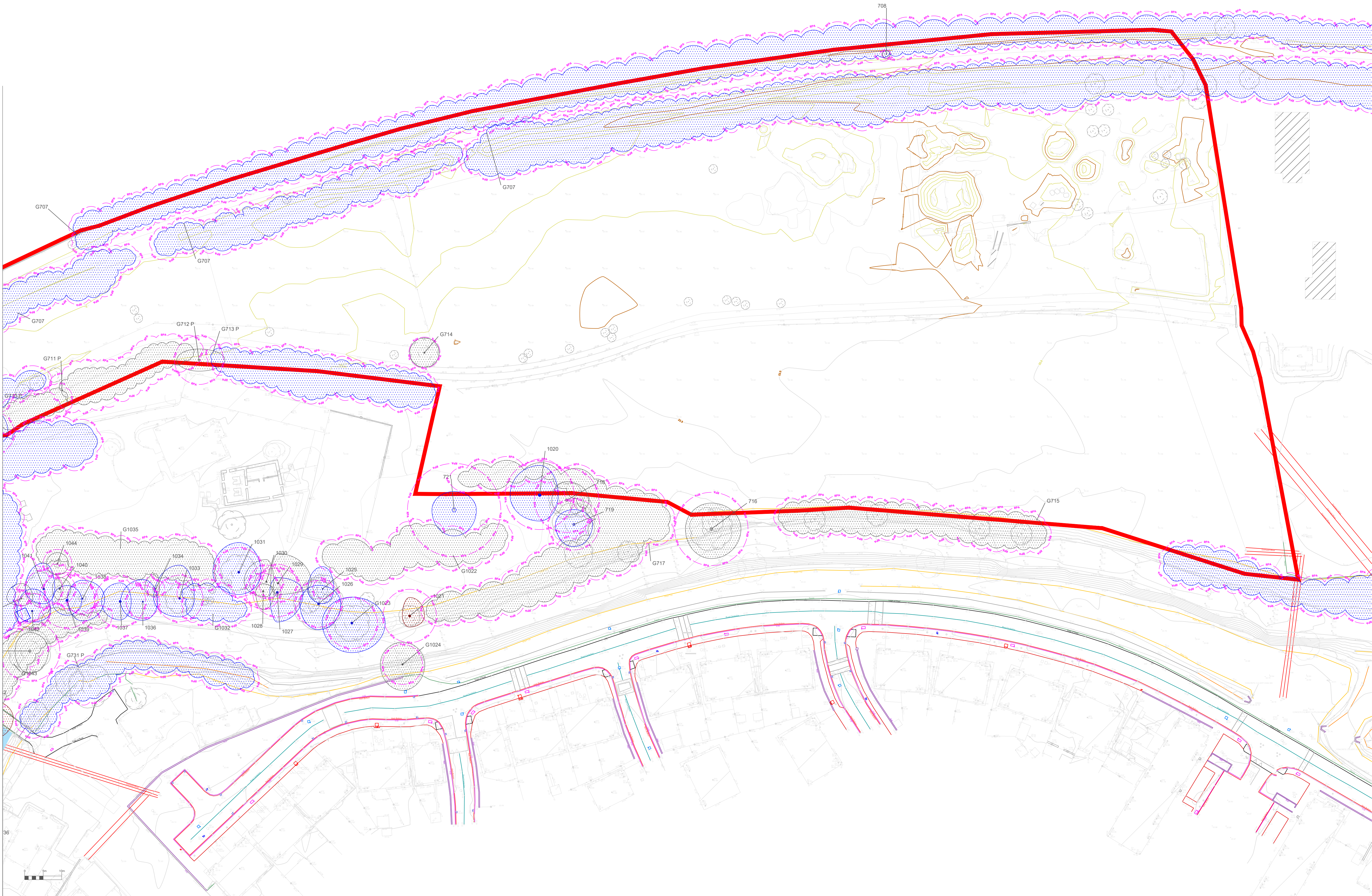

Category A (Tree stem and canopy spread)

Category B

Category C

Category U

Root Protection Area

Existing Layout

Site Boundary

Purpose of Tree Survey

The tree survey has been carried out in accordance with the recommendations of the Forestry Commission. The survey is in relation to design, demolition and Construction - Recommendations.

The purpose is to illustrate the constraints and opportunities posed by trees and hedgerows, to help the design team to make a more informed decision. It is not intended to prepare a report that is a consideration of the existing coverage on and within the site, and the degree of the site.

Caveats

Scale and hedge positions place reliance on topographical survey. The position of trees and hedgerows is not based on the topographical survey remains indicative.

Scale is for planning purposes only.

Plans should be prepared in colour and in conjunction with accompanying Tree Schedule.

BS5837 Retention Categories

The purpose of the tree categorisation method is to identify the quality and value (in a non-fiscal sense) of the existing tree stock, allowing informed decisions to be made on whether or not a tree should be removed or retained in the event of development.

Category A

Trees of high arboreal quality and value in such condition to make a significant contribution for a minimum life expectancy of 100 years.

Category B

Trees of moderate arboreal quality and value in such condition to make a substantial contribution for a minimum life expectancy of 75 years.

Category C

Trees of low arboreal quality and value and/or trees of low arboreal quality and value with a significant contribution to the landscape. A minimum life expectancy is established with a maximum life expectancy of 10 years, or trees with a life expectancy of 150 years.

Category D

Trees in poor physiological or structural condition that cannot realistically be retained in the context of the proposed development.

Ardee 2040

Louth County Council

21-217-02

v1

06.02.2022	SCALE: 1:500@A1
------------	--------------------

4 BY: JM	CHECKED BY: JL
----------	----------------

This drawing and its contents are the property of John Morris Agricultural Consultancy and must not be copied, reproduced or distributed without the consent of:



John Morris Arboricultural Consultancy Ltd
Executive Suite, Weavers Court, Linfield Road, Belfast, BT12 5GH
Email: info@johnmorristrees.com | Mobile: +44 (0) 7833 793 487
Web: www.johnmorristrees.com

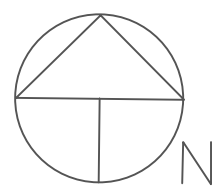

Example of Tree Protection Signs for Fencing



Example of Tree Protection Fencing

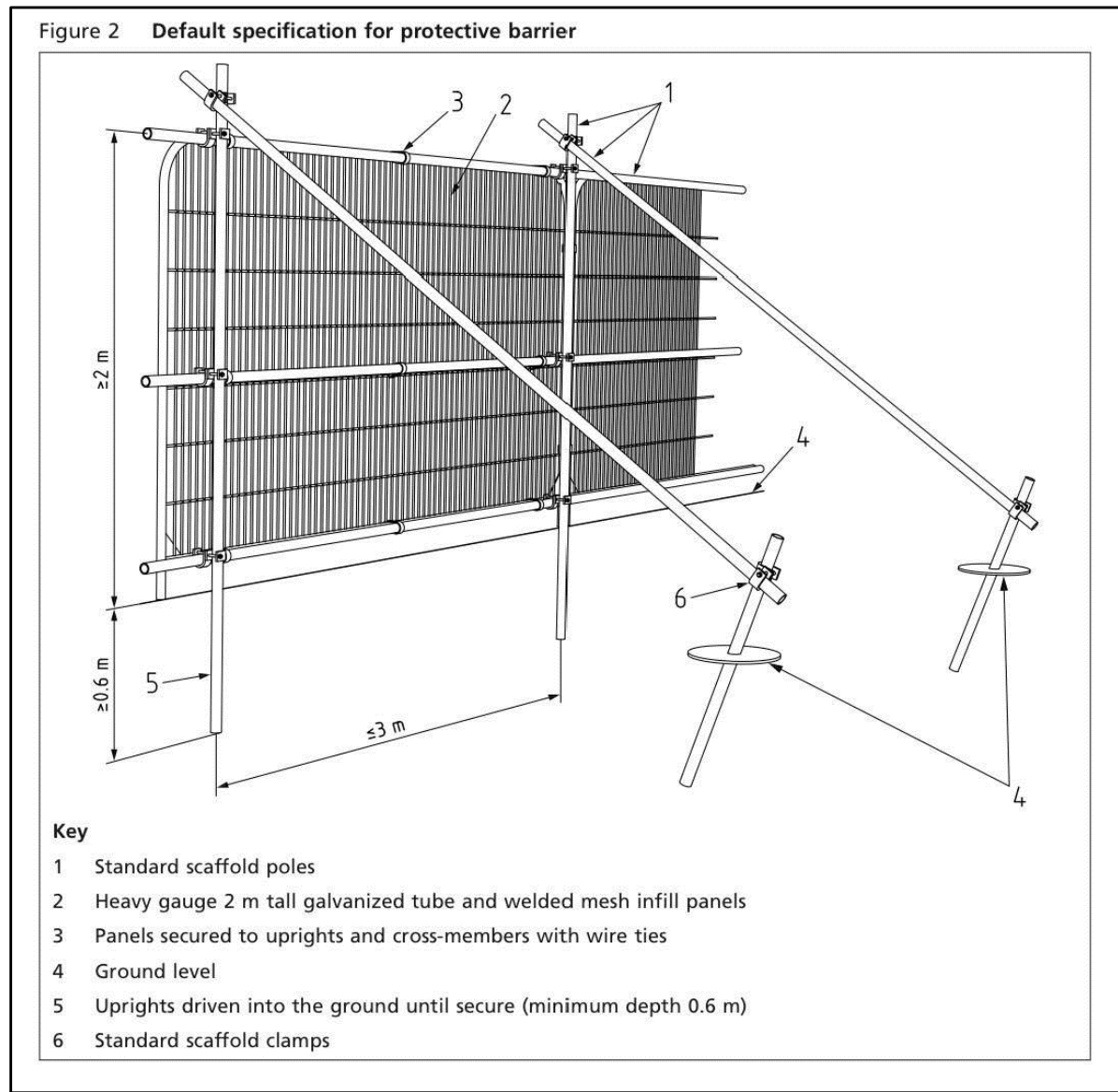

Woodland trail to be 'No-Dig' Construction using a three-dimensional cellular confinement system.

Tree protective fencing in accordance with BS5837: 2012.

Woodland trail to be 'No-Dig' Construction using a

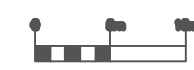

LEGEND

- Category A (Tree stem and canopy spread)
- Category B
- Category C
- Category U
- Root Protection Area
- Trees to be Removed
- Site Boundary
- Existing Layout
- Proposed Layout
- Tree Protection Fencing (area within forms 'Construction Exclusion Zone' and is required to protect tree roots, stems, canopies and soil)
- Permanent Ground Protection (No-Dig Construction)

NOTES

Purpose of Tree Survey
The tree survey has been carried out in accordance with BS5837:2012. Trees in relation to design, demolition and Construction - Recommendations.

The purpose is to illustrate the constraints and opportunities posed by trees and hedgerows, to help the design team prepare a layout that is considerate of the existing canopy cover on and within influencing distance of the site.

Caveats
Tree and hedgerow positions place reliance on topographical survey. The position of trees and hedgerows not recorded on the topographical survey remains indicative.

Scale is for planning purposes only.

Plan should be read in colour and in conjunction with accompanying Tree Schedule.

BS5837 Retention Categories
The purpose of the tree categorization method is to identify the quality and value (in a non-fiscal sense) of the existing tree stock, allowing informed decisions to be made concerning which trees should be removed or retained in the event of development occurring.

Category A
Trees of high arboricultural quality and value in such condition to make a significant contribution for a minimum of 40 years.

Category B
Trees of moderate arboricultural quality and value in such condition to make a substantial contribution for a minimum of 20 years.

Category C
Trees of low arboricultural quality and value currently in adequate condition and able to remain until new planting is established with a minimum useful life expectancy of 10 years, or trees with a stem diameter of <150mm.

Category U
Trees in poor physiological or structural condition that cannot realistically be retained in the context of current land use for longer than 10 years.

Date	Details of Change	By	Version
16.03.2022	Insert final layout	JM	1
02.05.2022	Insert revised final layout	JM	2
02.05.2022	Insert revised final layout	JM	3

TITLE:
Tree Impact & Protection Plan (Insert 1)

PROJECT / SITE:
Ardee 2040

CLIENT:
Louth County Council

DRAWING REF:
21-217-03

REVISION:
v1

DATE:
16.03.2022

SCALE:
1:500@A1

DRAWN BY:
JM

CHECKED BY:
JL

This drawing and its contents are the property of John Morris Arboricultural Consultancy and shall not be copied, reproduced or otherwise used without the written consent of John Morris Arboricultural Consultancy Ltd.

John Morris Arboricultural Consultancy Ltd
Executive Suite, Riverside Court, Lifford Road, Drogheda, D12 02N1
Email: info@johnmorris.ie | Website: www.johnmorristrees.com | Tel: 01 202 100 407

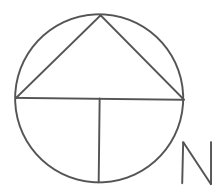

Woodland trail to be 'No-Dig' Construction using a three-dimensional cellular confinement system.

Woodland trail to be 'No-Dig' Construction using a three-dimensional cellular confinement system.

LEGEND

Category A (Tree stem and canopy spread)

Category B

Category C

Category U

Root Protection Area

Trees to be Removed

Site Boundary

Existing Layout

Proposed Layout

Tree Protection Fencing (area within forms 'Construction Exclusion Zone' and is required to protect tree roots, stems, canopies and soil)

Permanent Ground Protection (No-Dig Construction)

NOTES

Purpose of Tree Survey
The tree survey has been carried out in accordance with BS5837:2012. Trees in relation to design, demolition and Construction - Recommendations.

The purpose is to illustrate the constraints and opportunities posed by trees and hedgerows, to help the design team prepare a layout that is considerate of the existing canopy cover on and within influencing distance of the site.

Caveats
Tree and hedgerow positions place reliance on topographical survey. The position of trees and hedgerows not recorded on the topographical survey remains indicative.

Scale is for planning purposes only.

Plan should be read in colour and in conjunction with accompanying Tree Schedule.

BS5837 Retention Categories
The purpose of the tree categorization method is to identify the quality and value (in a non-fiscal sense) of the existing tree stock, allowing informed decisions to be made concerning which trees should be removed or retained in the event of development occurring.

Category A
Trees of high arboricultural quality and value in such condition to make a significant contribution for a minimum of 40 years.

Category B
Trees of moderate arboricultural quality and value in such condition to make a substantial contribution for a minimum of 20 years.

Category C
Trees of low arboricultural quality and value currently in adequate condition and able to remain until new planting is established with a minimum useful life expectancy of 10 years, or trees with a stem diameter of <150mm.

Category U
Trees in poor physiological or structural condition that cannot realistically be retained in the context of current land use for longer than 10 years.

Date	Details of Change	By	Version
16.03.22	Insert final layout	JM	1
09.07.24	Insert revised final layout	JM	2
02.05.22	Insert revised final layout	JM	3

TITLE: Tree Impact & Protection Plan (Insert 2)

PROJECT / SITE: Ardee 2040

CLIENT: Louth County Council

DRAWING REF: 21-217-03

REVISION: v1

DATE: 16.03.2022

SCALE: 1:500@A1

DRAWN BY: JM

CHECKED BY: JL

John Morris Arboricultural Consultancy Ltd

Executive Suite, Waters Court, Lifford Road, Drogheda, D12 5D1

Email: info@johnmorrisarboriculture.com | Website: www.johnmorristrees.com

© 2022 John Morris Arboricultural Consultancy Ltd



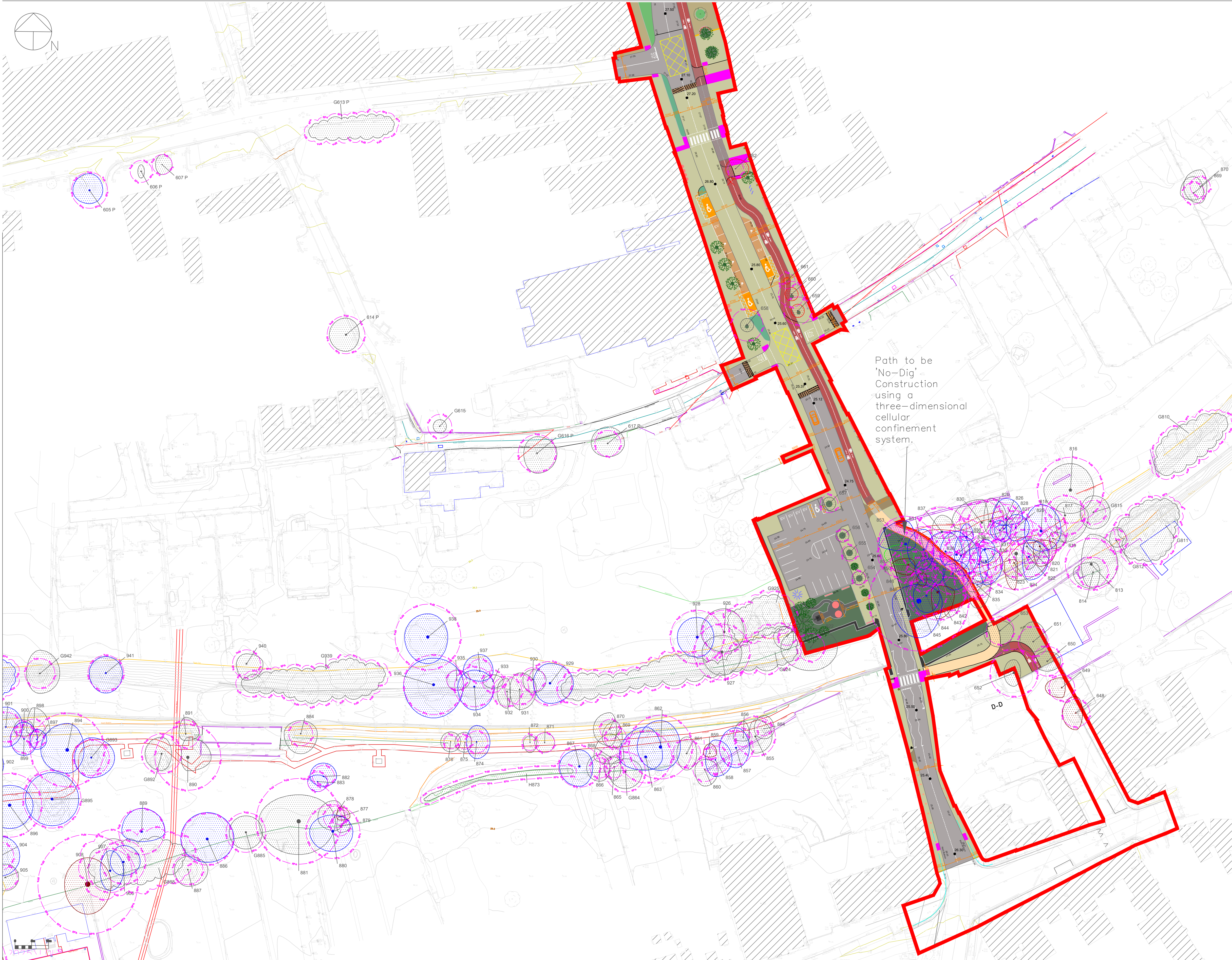

LEGEND

- Category A (Tree stem and canopy spread)
- Category B
- Category C
- Category U
- Root Protection Area
- Trees to be Removed
- Site Boundary
- Existing Layout
- Proposed Layout
- Tree Protection Fencing (area within forms 'Construction Exclusion Zone' and is required to protect tree roots, stems, canopies and soil)
- Permanent Ground Protection (No-Dig Construction)

NOTES

Purpose of Tree Survey
The tree survey has been carried out in accordance with BS5837:2012 Trees in relation to design, demolition and Construction - Recommendations.

The purpose is to illustrate the constraints and opportunities posed by trees and hedgerows, to help the design team prepare a layout that is considerate of the existing canopy cover on and within influencing distance of the site.

Caveats
Tree and hedgerow positions place reliance on topographical survey. The position of trees and hedgerows not recorded on the topographical survey remains indicative.

Scale is for planning purposes only.

Plan should be read in colour and in conjunction with accompanying Tree Schedule.

BS5837 Retention Categories
The purpose of the tree categorization method is to identify the quality and value (in a non-fiscal sense) of the existing tree stock, allowing informed decisions to be made concerning which trees should be removed or retained in the event of development occurring.

Category A
Trees of high arboricultural quality and value in such condition to make a significant contribution for a minimum of 40 years.

Category B
Trees of moderate arboricultural quality and value in such condition to make a substantial contribution for a minimum of 20 years.

Category C
Trees of low arboricultural quality and value currently in adequate condition and able to remain until new planting is established with a minimum useful life expectancy of 10 years, or trees with a stem diameter of <150mm.

Category U
Trees in poor physiological or structural condition that cannot realistically be retained in the context of current land use for longer than 10 years.

Date	Details of Change	By	Version
16.03.2022	Insert final layout	JM	1
02.05.2022	Insert revised final layout	JM	2
02.05.2022	Insert revised final layout	JM	3

TITLE:
Tree Impact & Protection Plan (Insert 4)

PROJECT / SITE:
Ardee 2040

CLIENT:
Louth County Council

DRAWING REF:
21-217-03

REVISION:
v1

DATE:
16.03.2022

SCALE:
1:500@A1

DRAWN BY:
JM

CHECKED BY:
JL

This drawing and its contents are the property of John Morris Arboricultural Consultancy and shall not be copied, reproduced or distributed without the consent of

John Morris Arboricultural Consultancy Ltd
Executive Suite, Riverside Court, Lifford Road, Drogheda, D12 12N
Email: info@johnmorristrees.com | Website: www.johnmorristrees.com | Tel: 01 202 100 407

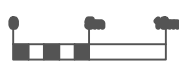
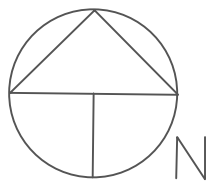

LEGEND

Category A (Tree stem and canopy spread)

Category B

Category C

Category U

Root Protection Area

Trees to be Removed

Site Boundary

Existing Layout

Proposed Layout

Tree Protection Fencing (area within forms 'Construction Exclusion Zone' and is required to protect tree roots, stems, canopies and soil)

Permanent Ground Protection (No-Dig Construction)

NOTES

Purpose of Tree Survey
The tree survey has been carried out in accordance with BS5837:2012 'Trees in relation to design, demolition and construction - Recommendations'.
The purpose is to illustrate the constraints and opportunities posed by trees and hedgerows, to help the design team prepare a layout that is considerate of the existing canopy cover on and within influencing distance of the site.

Caveats
Tree and hedgerow positions place reliance on topographical survey. The position of trees and hedgerows not recorded on the topographical survey remains indicative.
Scale is for planning purposes only.
Plan should be read in colour and in conjunction with accompanying Tree Schedule.

BS5837 Retention Categories
The purpose of the tree categorization method is to identify the quality and value (in a non-fiscal sense) of the existing tree stock, allowing informed decisions to be made concerning which trees should be removed or retained in the event of development occurring.

Category A
Trees of high arboricultural quality and value in such condition to make a significant contribution for a minimum of 40 years.

Category B
Trees of moderate arboricultural quality and value in such condition to make a substantial contribution for a minimum of 20 years.

Category C
Trees of low arboricultural quality and value currently in adequate condition and able to remain until new planting is established with a minimum useful life expectancy of 10 years, or trees with a stem diameter of <150mm.

Category U
Trees in poor physiological or structural condition that cannot realistically be retained in the context of current land use for longer than 10 years.

Date	Details of Change	By	Version
16.03.22	Insert final layout	JM	1
08.07.24	Insert revised final layout	JM	2
02.05.25	Insert revised final layout	JM	3

TITLE:
Tree Impact & Protection Plan (Insert 5)

PROJECT / SITE:
Ardee 2040

CLIENT:
Louth County Council

DRAWING REF:
21-217-03

REVISION:
v1

DATE:
16.03.2022

SCALE:
1:500@A1

DRAWN BY:
JM

CHECKED BY:
JL

This drawing and its contents are the property of John Morris Arboricultural Consultancy and shall not be copied, reproduced or published without the consent of

John Morris Arboricultural Consultancy Ltd
Executive Suite, Western Court, Lifford Road, Dublin, D12 12N1
Email: info@johnmorristrees.com | Tel: 01 708 193 467
Web: www.johnmorristrees.com

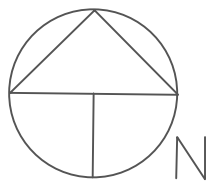

LEGEND

Category A (Tree stem and canopy spread)

Category B

Category C

Category U

Root Protection Area

Trees to be Removed

Site Boundary

Existing Layout

Proposed Layout

Tree Protection Fencing (area within Exclusion Zone and is required to protect tree roots, stems, canopies and soil)

Permanent Ground Protection (No-Dig Construction)

NOTES

Purpose of Tree Survey
The tree survey has been carried out in accordance with BS5837:2012 Trees in relation to design, demolition and Construction - Recommendations.

The purpose is to illustrate the constraints and opportunities posed by trees and hedgerows, to help the design team prepare a layout that is considerate of the existing canopy cover on and within influencing distance of the site.

Caveats
Tree and hedgerow positions place reliance on topographical survey. The position of trees and hedgerows not recorded on the topographical survey remains indicative.

Scale is for planning purposes only.

Plan should be read in colour and in conjunction with accompanying Tree Schedule.

BS5837 Retention Categories
The purpose of the tree categorization method is to identify the quality and value (in a non-fiscal sense) of the existing tree stock, allowing informed decisions to be made concerning which trees should be removed or retained in the event of development occurring.

Category A
Trees of high arboricultural quality and value in such condition to make a significant contribution for a minimum of 40 years.

Category B
Trees of moderate arboricultural quality and value in such condition to make a substantial contribution for a minimum of 20 years.

Category C
Trees of low arboricultural quality and value currently in adequate condition and able to remain until new planting is established with a minimum useful life expectancy of 10 years, or trees with a stem diameter of <150mm.

Category U
Trees in poor physiological or structural condition that cannot realistically be retained in the context of current land use for longer than 10 years.

Date	Details of Change	By	Version
16.03.2022	Insert final layout	JM	1
02.05.2022	Insert revised final layout	JM	2
02.05.2022	Insert revised final layout	JM	3

TITLE:
Tree Impact & Protection Plan (Insert 6)

PROJECT / SITE:
Ardee 2040

CLIENT:
Louth County Council

DRAWING REF:
21-217-03

REVISION:
v1

DATE:
16.03.2022

SCALE:
1:500@A1

DRAWN BY:
JM

CHECKED BY:
JL

This drawing and its contents are the property of John Morris Arboricultural Consultancy and shall not be copied, reproduced or published without the consent of

John Morris Arboricultural Consultancy Ltd
Executive Suite, Riverside Court, Lifford Road, Drogheda, D12 02N
Email: info@johnmorristrees.com | Tel: 01 202 100 100 | Fax: 01 202 100 101 | www.johnmorristrees.com

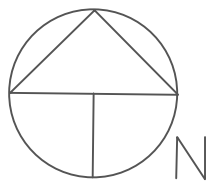

LEGEND

Category A (Tree stem and canopy spread)

Category B

Category C

Category U

Root Protection Area

Trees to be Removed

Site Boundary

Existing Layout

Proposed Layout

Tree Protection Fencing (area within Exclusion Zone and is required to protect tree roots, stems, canopies and soil)

Permanent Ground Protection (No-Dig Construction)

NOTES

Purpose of Tree Survey
The tree survey has been carried out in accordance with BS5837:2012. Trees in relation to design, demolition and construction - Recommendations.

The purpose is to illustrate the constraints and opportunities posed by trees and hedgerows, to help the design team prepare a layout that is considerate of the existing canopy cover on and within influencing distance of the site.

Caveats
Tree and hedgerow positions place reliance on topographical survey. The position of trees and hedgerows not recorded on the topographical survey remains indicative.

Scale is for planning purposes only.

Plan should be read in colour and in conjunction with accompanying Tree Schedule.

BS5837 Retention Categories
The purpose of the tree categorization method is to identify the quality and value (in a non-fiscal sense) of the existing tree stock, allowing informed decisions to be made concerning which trees should be removed or retained in the event of development occurring.

Category A
Trees of high arboricultural quality and value in such condition to make a significant contribution for a minimum of 40 years.

Category B
Trees of moderate arboricultural quality and value in such condition to make a substantial contribution for a minimum of 20 years.

Category C
Trees of low arboricultural quality and value currently in adequate condition and able to remain until new planting is established with a minimum useful life expectancy of 10 years, or trees with a stem diameter of <150mm.

Category U
Trees in poor physiological or structural condition that cannot realistically be retained in the context of current land use for longer than 10 years.

Date	Details of Change	By	Version
16.03.2022	Insert final layout	JM	1
02.05.2022	Insert revised final layout	JM	2
02.05.2022	Insert revised final layout	JM	3

TITLE: Tree Impact & Protection Plan (Insert 7)	
PROJECT / SITE:	Ardee 2040
CLIENT:	Louth County Council
DRAWING REF:	21-217-03
REVISION:	v1
DATE:	16.03.2022
SCALE:	1:500@A1
DRAWN BY:	JM
CHECKED BY:	JL